

REGULAR LEDs

PROMOLUX



# SLIMLINE EDGE LED



Works with 24V Constant Voltage LED Driver (sold separately)

## SLIMLINE SERIES

## SPECIFICATIONS

- Connectable in a Series up to 150W
- IP65
- 120° Beam Angle
- CRI: > 88+
- High R9 & R12 Values
- Power Factor: > 0.9
- Rated Life: 50,000 hrs
- Voltage Input: 24V
- Chips: 2835
- Colors: Platinum (PL), Premium White+ (PW+), 3500K (35), 4000K (40)



## 2 WAYS TO CONNECT

**LED to LED**  
Directly by the DC connector on both ends of the bar

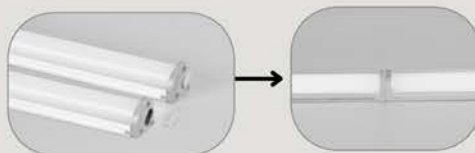

**SBE-CONNECT Connector / Jumper Cable** (optional purchase)

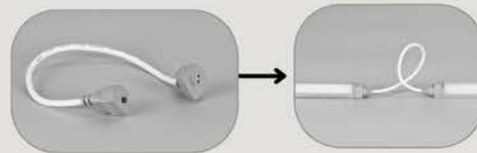

## TECHNICAL DATA SPECS

Available Color Formulas: Platinum (PL), Premium White+ (PW+), 3500K (35), 4000K (40)

SIZE	MODEL #	COLORS	WATTS	TYPE	LENGTH (mm) (Nominal)	LENGTH (in) (Nominal)	LUMENS
3 ft	SBE-XX-34C	PL, PW+, 35, 40	10.1	Full Brightness (Canopy)	858	34	1010
4 ft	SBE-XX-46C	PL, PW+, 35, 40	13.8	Full Brightness (Canopy)	1158	46	1380
3 ft	SBE-XX-34S	PL, PW+, 35, 40	5.8	60% Brightness (Shelf)	858	34	600
4 ft	SBE-XX-46S	PL, PW+, 35, 40	7.5	60% Brightness (Shelf)	1158	46	750

Specifications subject to color/kelvin chosen. Specifications subject to change without notice; contact us for more information.

# ACCESSORIES

## Included

Special angular mounting bracket with strong magnet can be clipped on to the back of the light bar, so the LED light bar is adjustable. The mounting bracket can be fixed by screws or magnet. **4 mounting brackets total: 0°, 30°, 45°, 60°**

### 0° Mounting Brackets



### 30° Mounting Brackets



### 45° Mounting Brackets



### 60° Mounting Brackets



**Silicon end cap (included)**



## Dimensions

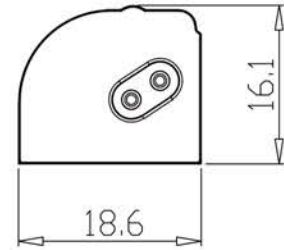

## INSTALLATION

### 2 Different Ways

#### 01 Using pre-installed magnets

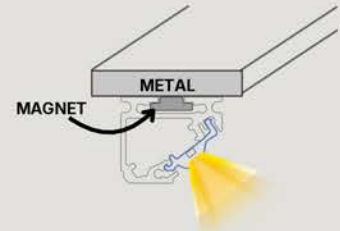

#### 02 Using Mounting Clips (multiple angles) & Screws (included)

